

# ACOUSTICAL FOLDING PARTITION

## INSTALLATION INSTRUCTIONS - READ CAREFULLY

Tools Required: Electric Drill, Phillips Head Screwdriver (bit), Hacksaw,  
Flat Blade Screwdriver, Caulking Gun, 1/2" Stapler.

### SECTION 1

#### Installation of Single Partitions

Partition track is pre-punched on  
**8"(203.2mm)** centers for heights  
thru **12'-1"(3683mm)**,  
**4"(101.6mm)** centers for heights  
over **12'-1"(3683mm)**



No.12 x 1-3/4"  
Pan Head Screw

Panhead sheet metal screws are furnished:  
**No.12 x 1-3/4"** for track type "A"  
**No.14 x 2"** for track type "C"

Should other screws or fasteners be used,  
the head size must be not larger than those  
furnished.



No.14 x 2"  
Pan Head Screw

### STEP 1

- A. Mark and pre-drill header to match holes in track. Extreme care shall be taken to prevent shavings or any other foreign material getting into track.

#### **DO NOT DRILL THRU TRACK**

If more than one track section is supplied,  
care must be taken where the two track ends  
meet to secure them to the header in precise  
alignment to assure smooth, trouble-free  
travel of the carriers.



## STEP 1(Cont'd)

- B. **REMOVE END CAPS ONLY** from (Main crate must not be removed until is suspended in track). Carefully stand on bottom with top wheels directly beneath track location.

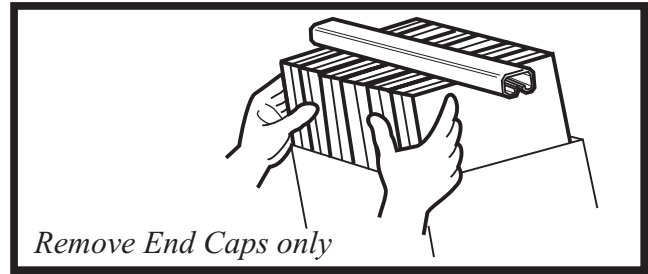

- C. Thread track onto wheels and begin installing track screws at far end. Secure enough screws to support in a partially extended position. Remove remaining crate and inner packing. Very carefully move to the secured portion of the track. Install remaining screws in track.

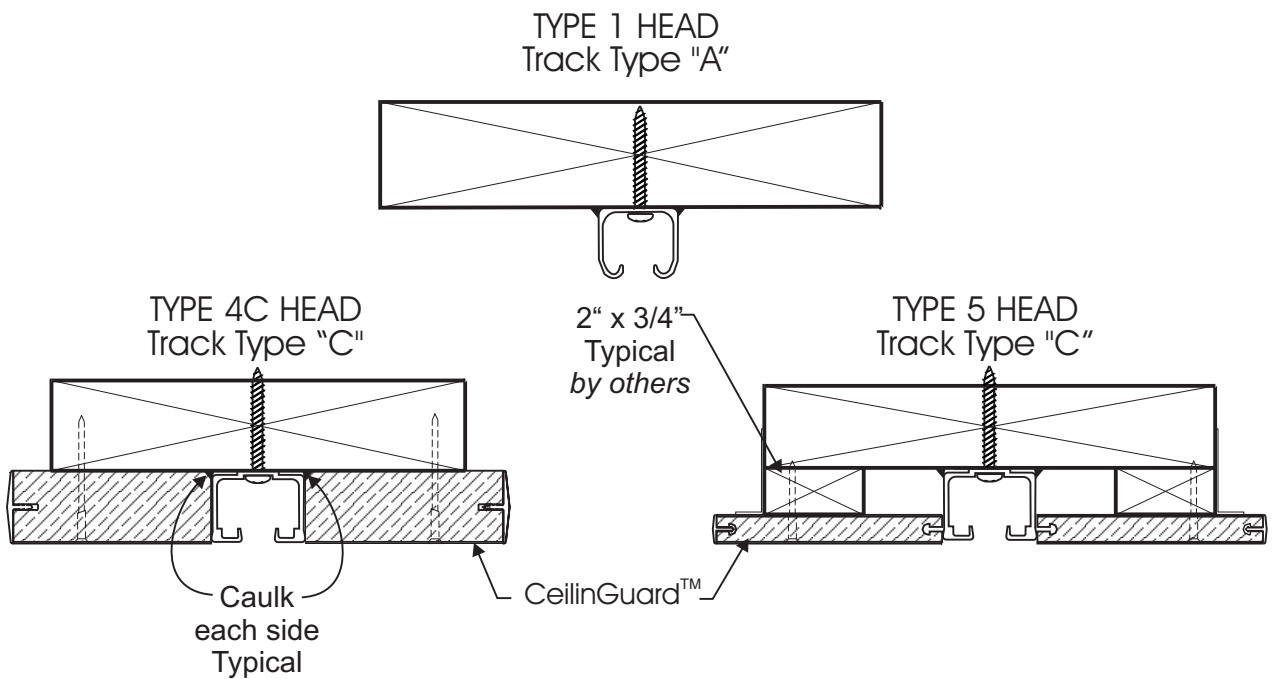
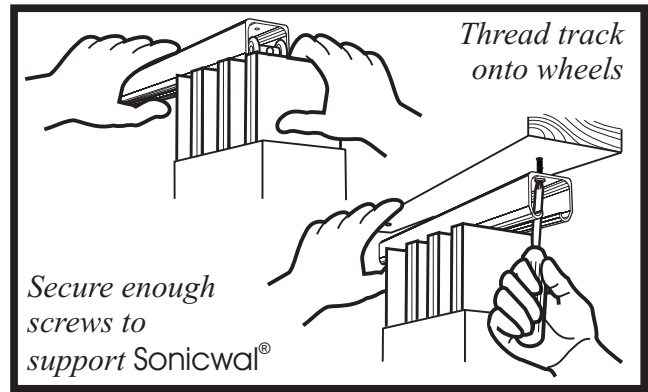

- D. In **Type 4C** heads install CeilinGuard® head trim at each side of track with No.8 x 2¼" flat head screws. Use No.6 x 1½" flat head screws for **Type 5** heads. Great care shall be taken to assure a level surface (no side tilt) for SonicSweep™ (sweep seal) material to contact without binding.

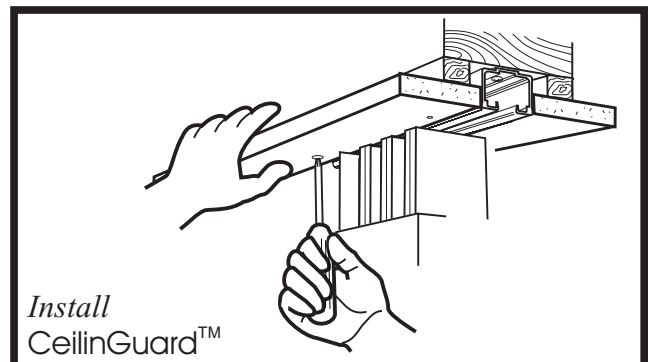

## STEP 2

- A. Place jamb stud in a plumb position directly under track. Secure with No.8 x 2¼" flat head screws to jambs or finished wall.
- B. Carefully mate the jamb attaching panels with the secured jamb stud. See that jamb panels are snug against the finished jamb; then secure with No.6 x 1½" flat head screws.

## STEP 3

- A. Place jamb mould (for Single-Fixed Jamb or Double-End Post Partitions) in a plumb position directly under the track. Secure with flat head screws supplied.

**Note: Should it become necessary to shorten the jamb mould, cut off bottom only**

- B. Latch operation can be adjusted by turning the adjusting screw located in the leading edge of latch (See bottom figures).

## STEP 4

- A. Bottom may be adjusted for proper floor contact. To adjust, extend and latch partition. Loosen retaining bolts and pull down on bottom sweep seal until it contacts the floor evenly. **DO NOT OVER EXTEND.** Tighten retaining bolts. Repeat procedure on the other side of partition.

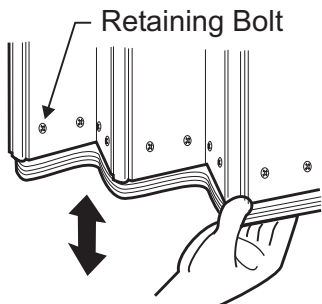

*Bottom SonicSweep™ adjustment*

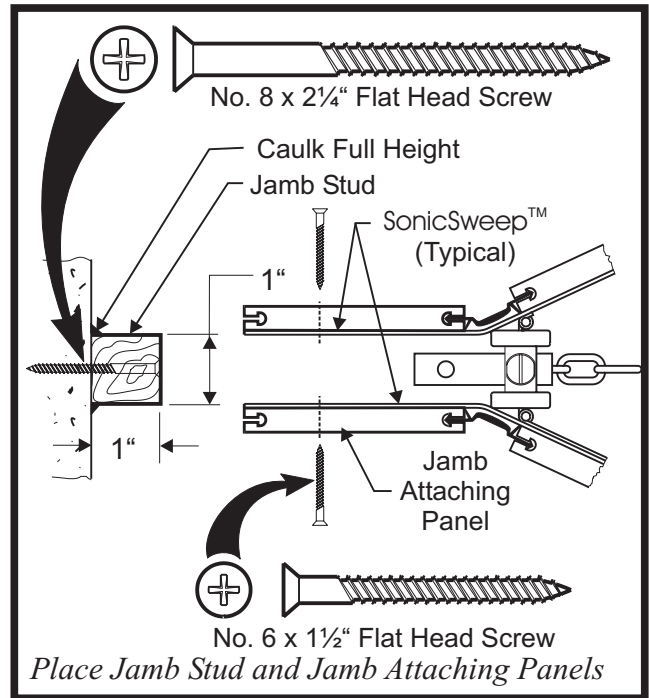

*Place Jamb Stud and Jamb Attaching Panels*

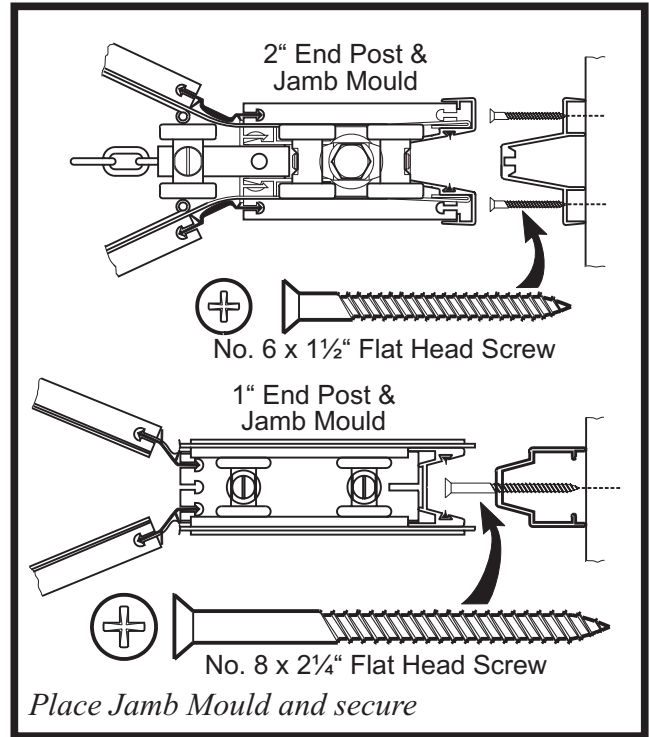

*Place Jamb Mould and secure*

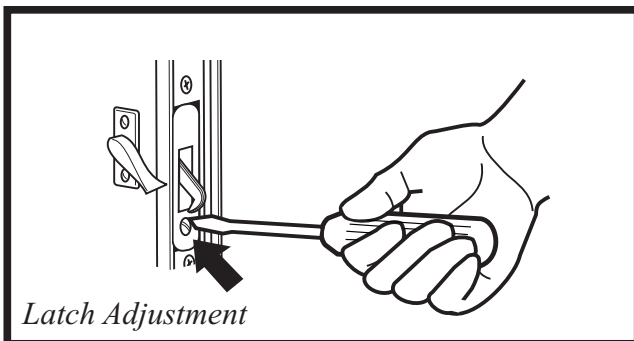

*Latch Adjustment*

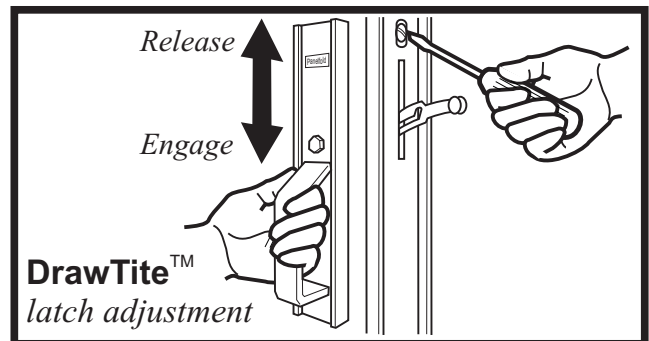

## SECTION 2 Installation of Double Partitions

- A. Measure opening width and divide the result by two (2). Cut each track section 1/8" (3.175mm) shorter than measurement. This leaves room for screw "stop" when track is installed.
- B. Follow **STEPS 1A** and **1B** except placing both partitions opposing each other directly under one half of opening,
- C. Thread first half of track onto wheels of both partitions and begin installing track screws as in **STEP 1C**.  
After securing all track screws in one half of track, install second half of track.  
Move second partition to second half of track. Set a screw at track center joint and leave projecting 1/2" (12.7mm) to "stop" wheels of either partition from traveling pass the joint.
- D. Follow partition installation **Step 2**.

## SECTION 3 Assembly of Partitions Shipped in Sections

- A. If partition comes in more than one crate it is necessary to assemble the sections. Follow **STEP 1A**, **1B**, and **1C**, **STEP 2A & 2B**, **STEP 3A** and **STEP 4** for each of the sections. Then attach the chain connecting the sections.
- B. Secure the sweep seals top and bottom by loosening retaining bolts on both sides and inserting the sweep seals between support brackets and panels. Tighten bolts.
- C. Insert the dual-walled MemoryAction® vinyl hinges from the top into the grooves in the panel edges. Staple and trim.

**PARTITION TRACK MUST BE THOROUGHLY LUBRICATED WITH LUBRIPLATE OR SIMILAR PRODUCT FOR EASY AND TROUBLE-FREE OPERATION**

Insert Track Screw half way to provide a "stop" at the center of opening for Double Partitions

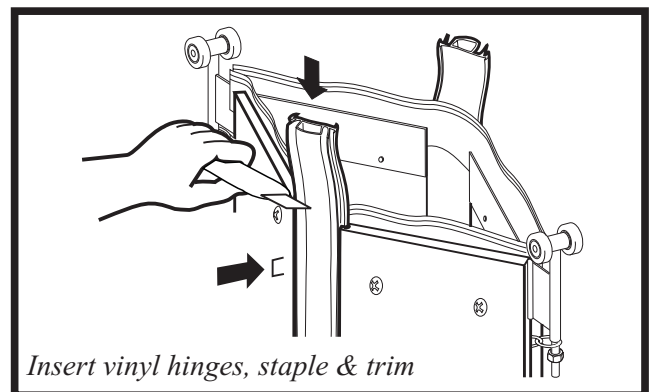
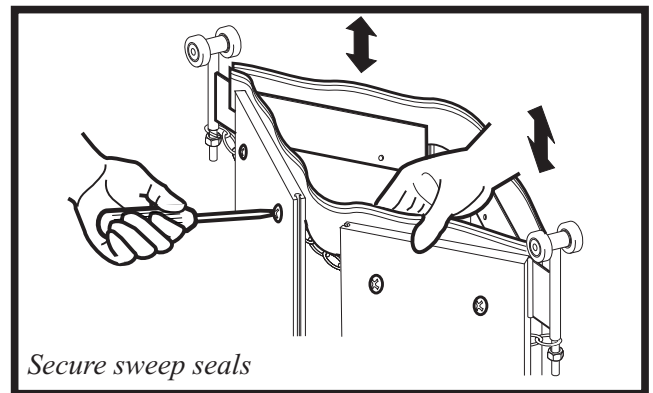
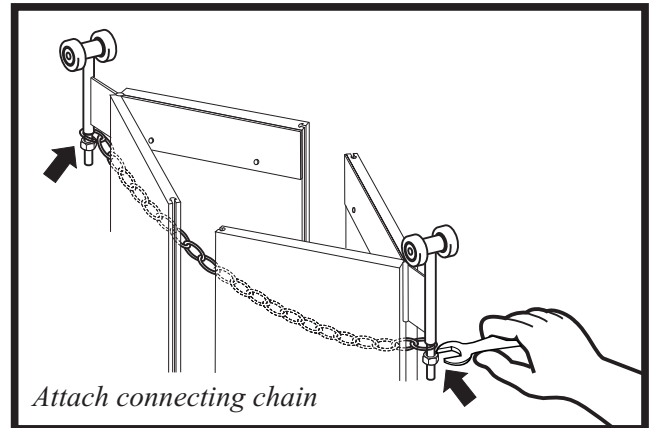
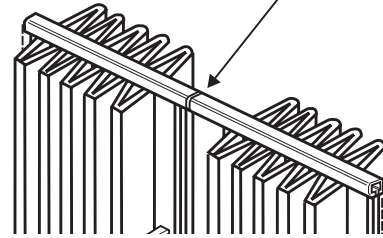

**CAUTION: NEVER STORE ON END  
Keep in carton until ready to install**